

# CYLINDERS



## Tapered Cylinders

### DESCRIPTION

Crown Plastics tapered cylinders are designed for commercial and residential post top application.

### MATERIALS

- **Polycarbonate** - UV stabilized with continuous operating temperature of 100°C to 125°C and high impact resistance down to -40°C, transmittance of 88% (application dependent). Polycarbonate tapered cylinders are available in clear or white.
- **Acrylic** - UV resistant with continuous operating temperature up to 80°C. Maximum transmittance of 92% (clear). Acrylic tapered cylinders are available in clear or white.
- **LD Acrylic** - UV resistant with continuous operating temperature up to 80°C and transmittance of 90% to 94% (application dependent).

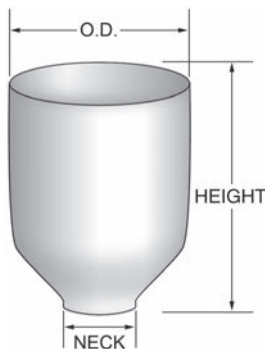
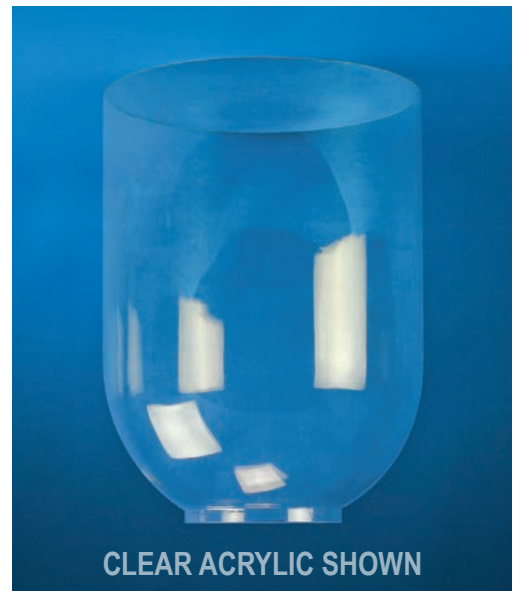

ITEM NO.	OD	HEIGHT	ID (NECK)	OD (NECK)	MATERIAL	COLOR
25900-CL	11.88"	16.00"	5.50"	5.75"	Acrylic	Clear
25900-WH	11.88"	16.00"	5.50"	5.75"	Acrylic	White
25900-LD	11.88"	16.00"	5.50"	5.75"	LD Acrylic	Frost
15900-CL	11.88"	16.00"	5.50"	5.75"	Polycarbonate	Clear
15900-WH	11.88"	16.00"	5.50"	5.75"	Polycarbonate	White

## MAXIMUM TEMPERATURES

No warranty or guarantee is expressed or implied as only the user can determine the suitability of a product for his or her purpose.

Maximum working temperature is 80° C for Acrylic and between 100° C and 125° C for Polycarbonates, depending on products chosen.

Actual wattage ratings are influenced by many factors including Fixture Type, Bulb Location and Ambient Temperature.

## ITEM NUMBER SUFFIX CODES

STYLE NUMBER	COLOR
25900 = Acrylic	CL = CLEAR
15900 = Polycarbonate	WH = WHITE
	LD = Frost

Dimensions are nominal

## Flanged Tapered Cylinders

### DESCRIPTION

Crown Plastics flanged tapered cylinders are designed for commercial and residential post top application.

### MATERIALS

- **Polycarbonate** - UV stabilized with continuous operating temperature of 100°C to 125°C and high impact resistance down to -40°C, transmittance of 88% (application dependent). Polycarbonate tapered cylinders are available in clear or white.
- **Acrylic** - UV resistant with continuous operating temperature up to 80°C. Maximum transmittance of 92% (clear). Acrylic tapered cylinders are available in clear or white.
- **LD Acrylic** - UV resistant with continuous operating temperature up to 80°C and transmittance of 90% to 94% (application dependent).

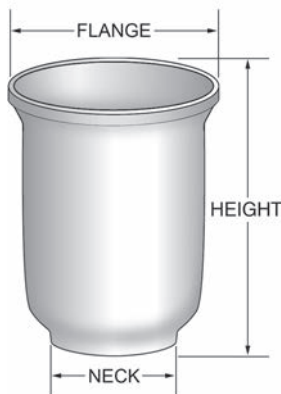

ITEM NO.	OD (FLANGE)	HEIGHT	ID (NECK)	OD (NECK)	MATERIAL	COLOR
25901-CL	12.27"	16.35"	7.22"	7.40"	Acrylic	Clear
25901-WH	12.27"	16.35"	7.22"	7.40"	Acrylic	White
25901-LD	12.27"	16.35"	7.22"	7.40"	LD Acrylic	Frost
25902-CL	11.00"	13.50"	7.25"	7.50"	Acrylic	Clear
25902-WH	11.00"	13.50"	7.25"	7.50"	Acrylic	White
25902-LD	11.00"	13.50"	7.25"	7.50"	LD Acrylic	Frost
15901-CL	12.27"	16.35"	7.22"	7.40"	Polycarbonate	Clear
15901-WH	12.27"	16.35"	7.22"	7.40"	Polycarbonate	White
15902-CL	11.00"	13.50"	7.25"	7.50"	Polycarbonate	Clear
15902-WH	11.00"	13.50"	7.25"	7.50"	Polycarbonate	White

## MAXIMUM TEMPERATURES

No warranty or guarantee is expressed or implied as only the user can determine the suitability of a product for his or her purpose.

Maximum working temperature is 80° C for Acrylic and between 100° C and 125° C for Polycarbonates, depending on products chosen.

Actual wattage ratings are influenced by many factors including Fixture Type, Bulb Location and Ambient Temperature.

## ITEM NUMBER SUFFIX CODES

STYLE NUMBER	COLOR
2590X = Acrylic	CL = CLEAR
1590X = Polycarbonate	WH = WHITE
	LD = Frost

Dimensions are nominal

## Hourglass Lens

### DESCRIPTION

Crown Plastics hourglass lenses are designed for commercial and residential post top application.

### MATERIALS

- **Polycarbonate** - UV stabilized with continuous operating temperature of 100°C to 125°C and high impact resistance down to -40°C, transmittance of 88% (application dependent). Polycarbonate tapered cylinders are available in clear or white.
- **Acrylic** - UV resistant with continuous operating temperature up to 80°C. Maximum transmittance of 92% (clear). Acrylic tapered cylinders are available in clear or white.
- **LD Acrylic** - UV resistant with continuous operating temperature up to 80°C and transmittance of 90% to 94% (application dependent).

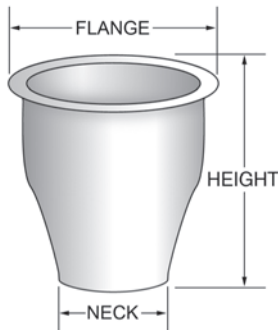

ITEM NO.	OD (FLANGE)	HEIGHT	ID (NECK)	OD (NECK)	MATERIAL	COLOR
25910-CL	14.50"	12.50"	7.62"	7.81"	Acrylic	Clear
25910-WH	14.50"	12.50"	7.62"	7.81"	Acrylic	White
25910-LD	14.50"	12.50"	7.62"	7.81"	LD Acrylic	Frost
15910-CL	14.50"	12.50"	7.62"	7.81"	Polycarbonate	Clear
15910-WH	14.50"	12.50"	7.62"	7.81"	Polycarbonate	White

## MAXIMUM TEMPERATURES

No warranty or guarantee is expressed or implied as only the user can determine the suitability of a product for his or her purpose.

Maximum working temperature is 80° C for Acrylic and between 100° C and 125° C for Polycarbonates, depending on products chosen.

Actual wattage ratings are influenced by many factors including Fixture Type, Bulb Location and Ambient Temperature.

## ITEM NUMBER SUFFIX CODES

STYLE NUMBER	COLOR
25910 = Acrylic	CL = CLEAR
15910 = Polycarbonate	WH = WHITE
	LD = Frost

Dimensions are nominal

## 6" Smooth Cylinders

### DESCRIPTION

Crown Plastics cylinders are designed for commercial and residential applications and are available with fitter neck and screw neck.

### MATERIALS

- **Acrylic** - UV resistant with continuous operating temperature up to 80°C. Maximum transmittance of 92% (clear). Acrylic cylinders are available in clear or white



### FITTER NECK (F)

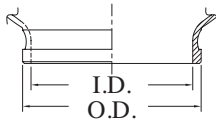

ITEM NO.	HEIGHT	WIDTH	ID (NECK)	OD (NECK)	MATERIAL	COLOR
25006-WH-3F	6.12"	3.75"	2.81"	3.14"	Acrylic	White

### SCREW NECK (S)

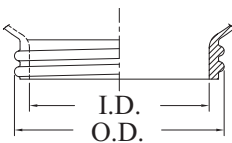

ITEM NO.	HEIGHT	WIDTH	ID (NECK)	OD (NECK)	MATERIAL	COLOR
25006-WH-3S	6.12"	3.75"	2.81"	3.24"	Acrylic	White

## MAXIMUM TEMPERATURES

No warranty or guarantee is expressed or implied as only the user can determine the suitability of a product for his or her purpose.

Maximum working temperature is 80° C for Acrylic and between 100° C and 125° C for Polycarbonates, depending on products chosen.

Actual wattage ratings are influenced by many factors including Fixture Type, Bulb Location and Ambient Temperature.

## ITEM NUMBER SUFFIX CODES

STYLE NUMBER	COLOR	NECK
25006 = Acrylic	CL = CLEAR WH = WHITE	3S = 3.24" Screw 3F = 3.14" Fitter

Dimensions are nominal

## 6" Prismatic Cylinders

### DESCRIPTION

Crown Plastics prismatic cylinders are designed for commercial and residential applications and are available with fitter neck, and screw neck.

### MATERIALS

- **Polycarbonate** - UV stabilized with continuous operating temperature of 100°C to 125°C and high impact resistance down to -40°C, transmittance of 88% (application dependent). Polycarbonate tapered cylinders are available in clear or white.
- **Acrylic** - UV resistant with continuous operating temperature up to 80°C. Maximum transmittance of 92% (clear). Acrylic cylinders are available in clear or white

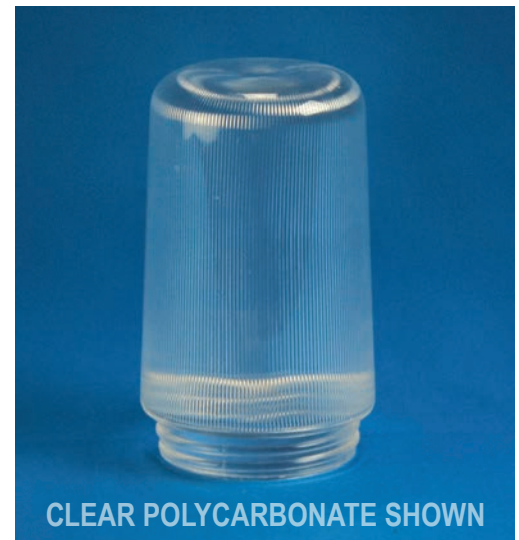

### FITTER NECK (F)

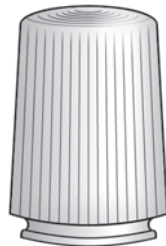
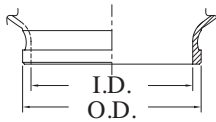

ITEM NO.	HEIGHT	WIDTH	ID (NECK)	OD (NECK)	MATERIAL	COLOR
25106-CL-3F	6.12"	3.75"	2.81"	3.14"	Acrylic	Clear
25106-WH-3F	6.12"	3.75"	2.81"	3.14"	Acrylic	White

### SCREW NECK (S)

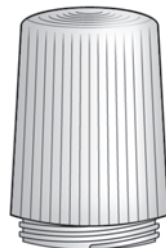
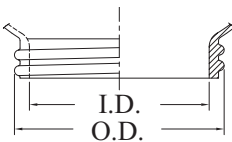

ITEM NO.	HEIGHT	WIDTH	ID (NECK)	OD (NECK)	MATERIAL	COLOR
25106-CL-3S	6.12"	3.50"	2.81"	3.24"	Acrylic	Clear
25106-WH-3S	6.12"	3.50"	2.81"	3.24"	Acrylic	White
15106-CL-3S	6.12"	3.50"	2.81"	3.24"	Polycarbonate	Clear

### MAXIMUM TEMPERATURES

No warranty or guarantee is expressed or implied as only the user can determine the suitability of a product for his or her purpose.

Maximum working temperature is 80° C for Acrylic and between 100° C and 125° C for Polycarbonates, depending on products chosen.

Actual wattage ratings are influenced by many factors including Fixture Type, Bulb Location and Ambient Temperature.

### ITEM NUMBER SUFFIX CODES

STYLE NUMBER	COLOR	NECK
25106 = Acrylic	CL = CLEAR WH = WHITE	3S = 3.24" Screw 3F = 3.14" Fitter
15106 = Polycarbonate	CL = CLEAR	3S = 3.24" Screw 3F = 3.14" Fitter

Dimensions are nominal

## 6" Prismatic Domed Cylinders

### DESCRIPTION

Crown Plastics prismatic domed cylinders are designed for commercial and residential applications and are available with fitter neck and screw neck.

### MATERIALS

- **Polycarbonate** - UV stabilized with continuous operating temperature of 100°C to 125°C and high impact resistance down to -40°C, transmittance of 88% (application dependent). Polycarbonate cylinders are available in clear or white.
- **Acrylic** - UV resistant with continuous operating temperature up to 80°C. Maximum transmittance of 92% (clear). Acrylic cylinders are available in clear or white.



### FITTER NECK (F)

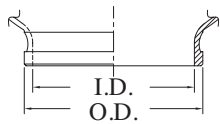

ITEM NO.	HEIGHT	WIDTH	ID (NECK)	OD (NECK)	MATERIAL	COLOR
25105-CL-3F	6.66"	4.00"	2.81"	3.14"	Acrylic	Clear
25105-WH-3F	6.66"	4.00"	2.81"	3.14"	Acrylic	White
15105-CL-3F	6.66"	4.00"	2.81"	3.14"	Polycarbonate	Clear
15105-WH-3F	6.66"	4.00"	2.81"	3.14"	Polycarbonate	White

### SCREW NECK (S)

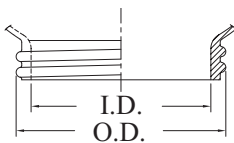

ITEM NO.	HEIGHT	WIDTH	ID (NECK)	OD (NECK)	MATERIAL	COLOR
25105-CL-3S	6.66"	4.00"	2.81"	3.24"	Acrylic	Clear
25105-WH-3S	6.66"	4.00"	2.81"	3.24"	Acrylic	White
15105-CL-3S	6.66"	4.00"	2.81"	3.24"	Polycarbonate	Clear
15105-WH-3S	6.66"	4.00"	2.81"	3.24"	Polycarbonate	White

### MAXIMUM TEMPERATURES

No warranty or guarantee is expressed or implied as only the user can determine the suitability of a product for his or her purpose.

Maximum working temperature is 80° C for Acrylic and between 100° C and 125° C for Polycarbonates, depending on products chosen.

Actual wattage ratings are influenced by many factors including Fixture Type, Bulb Location and Ambient Temperature.

### ITEM NUMBER SUFFIX CODES

STYLE NUMBER	COLOR	NECK
25105 = Acrylic	CL = CLEAR	3F= 3.14" Fitter
15105 = Polycarbonate	WH = WHITE	3S= 3.24" Screw

Dimensions are nominal

## 8" Prismatic Cylinders

### DESCRIPTION

Crown Plastics prismatic cylinders are designed for commercial and residential applications and are available with fitter neck and screw neck.

### MATERIALS

- **Polycarbonate** - UV stabilized with continuous operating temperature of 100°C to 125°C and high impact resistance down to -40°C, transmittance of 88% (application dependent). Polycarbonate cylinders are available in clear or white.
- **Acrylic** - UV resistant with continuous operating temperature up to 80°C. Maximum transmittance of 92% (clear). Acrylic cylinders are available in clear or white.



### FITTER NECK (F)

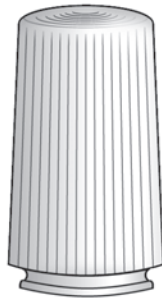
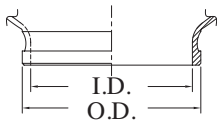

ITEM NO.	HEIGHT	WIDTH	ID (NECK)	OD (NECK)	MATERIAL	COLOR
25108-CL-3F	7.80"	4.00"	2.81"	3.14"	Acrylic	Clear
25108-WH-3F	7.80"	4.00"	2.81"	3.14"	Acrylic	White
15108-CL-3F	7.80"	4.00"	2.81"	3.14"	Polycarbonate	Clear
15108-WH-3F	7.80"	4.00"	2.81"	3.14"	Polycarbonate	White

### SCREW NECK (S)

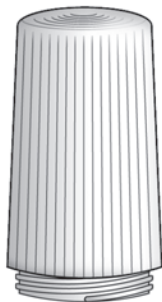

ITEM NO.	HEIGHT	WIDTH	ID (NECK)	OD (NECK)	MATERIAL	COLOR
25108-CL-3S	7.80"	4.00"	2.81"	3.24"	Acrylic	Clear
25108-WH-3S	7.80"	4.00"	2.81"	3.24"	Acrylic	White
15108-CL-3S	7.80"	4.00"	2.81"	3.24"	Polycarbonate	Clear
15108-WH-3S	7.80"	4.00"	2.81"	3.24"	Polycarbonate	White

### MAXIMUM TEMPERATURES

No warranty or guarantee is expressed or implied as only the user can determine the suitability of a product for his or her purpose.

Maximum working temperature is 80° C for Acrylic and between 100° C and 125° C for Polycarbonates, depending on products chosen.

Actual wattage ratings are influenced by many factors including Fixture Type, Bulb Location and Ambient Temperature.

### ITEM NUMBER SUFFIX CODES

STYLE NUMBER	COLOR	NECK
25108 = Acrylic	CL = CLEAR	3F= 3.14" Fitter
15108 = Polycarbonate		3S= 3.24" Screw

Dimensions are nominal



## Series 25001 Jelly Jars

### DESCRIPTION

Crown Plastics jelly jars are designed for commercial and residential applications and are available with fitter and screw necks.

### MATERIALS

- **Acrylic** - UV resistant with continuous operating temperature up to 80°C. Maximum transmittance of 92% (clear). Acrylic jelly jars are available in clear.



### FITTER NECK (F)

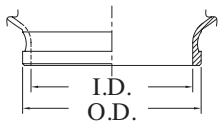

ITEM NO.	HEIGHT	WIDTH	ID (NECK)	OD (NECK)	MATERIAL	COLOR
25001-CL-3F	6.00"	3.50"	2.81"	3.14"	Acrylic	Clear

### SCREW NECK (S)

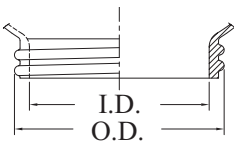

ITEM NO.	HEIGHT	WIDTH	ID (NECK)	OD (NECK)	MATERIAL	COLOR
25001-CL-3S	6.00"	3.50"	2.81"	3.24"	Acrylic	Clear

### MAXIMUM TEMPERATURES

No warranty or guarantee is expressed or implied as only the user can determine the suitability of a product for his or her purpose. Maximum working temperature is 80° C for Acrylic and between 100° C and 125° C for Polycarbonates, depending on products chosen. Actual wattage ratings are influenced by many factors including Fixture Type, Bulb Location and Ambient Temperature.

### ITEM NUMBER SUFFIX CODES

STYLE NUMBER	COLOR	NECK
25001 = Acrylic	CL = CLEAR	3F= 3.14" Fitter 3S= 3.24" Screw

Dimensions are nominal